

John Ross

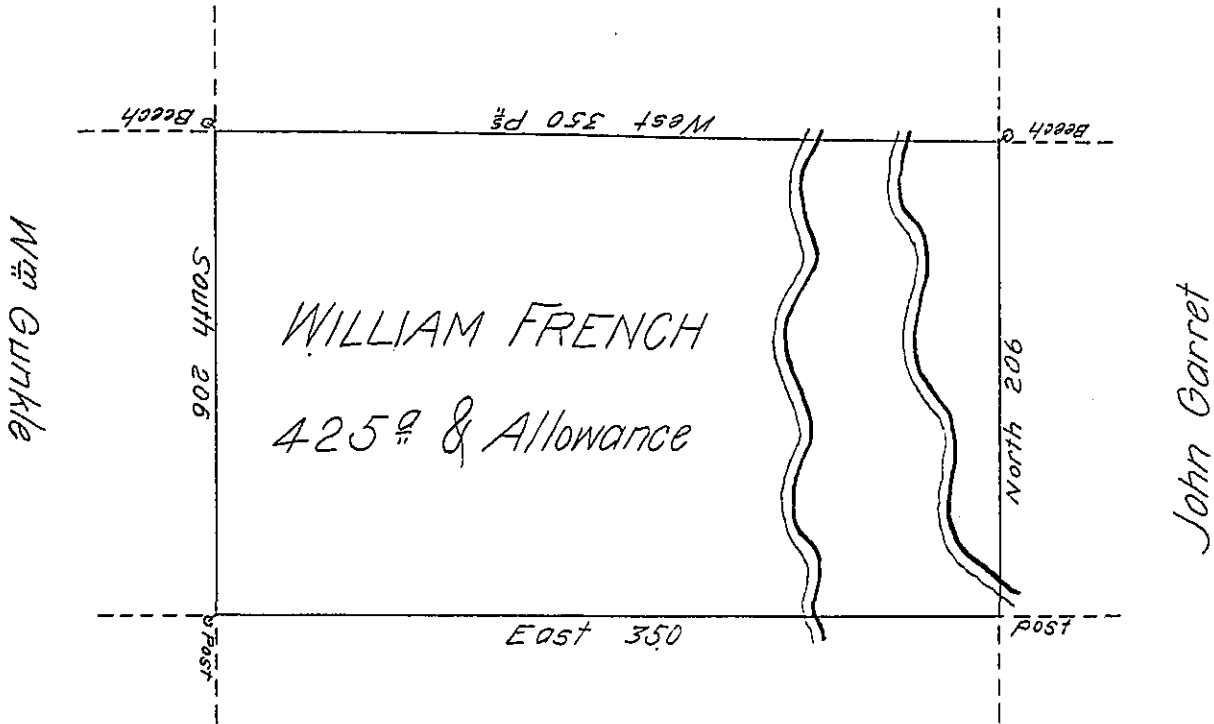

Henry Pratt

Draught of a tract of Land Called Situate on the Waters of Snake Creek  
 Joining Land Surveyed for Henry Pratt and others in Stoke Township North  
 County, Containing four hundred & twenty five acres & Allowance of Six PCent  
 for Roads &c Surveyed for W<sup>m</sup> French the 14<sup>th</sup> Day of Septemb<sup>r</sup> 1784 in pur-  
 suance of a Warrant Dated the 24<sup>th</sup> Day of August 1784.

To John Lukens Esq.  
 Surv<sup>r</sup> Genl

by  
 W<sup>m</sup> Gray D.S.

IN TESTIMONY that the above is a copy of the original remaining on file in  
 the Department of Internal Affairs of Pennsylvania, made  
 conformably to an Act of Assembly approved the 16th day of  
 February, 1833, I have hereunto set my Hand and caused  
 the Seal of said Department to be affixed at Harrisburg,  
 this twenty ninth day of November 1904

*George R. Brown*  
 Secretary of Internal Affairs